

SDC Newsletter - July 2011

Live Every Saturday - 12 Noon to 1PM Eastern
"Bill's Green Architect Show"

Saturday July 23, 2011
GREEN WATER DESIGN: SITE PLANNING
& PLUMBING INSIDE

In-Studio Guest: Joe Schaffer, Civil Engineer, PE, LEED-AP
JFS Engineering, Metuchen, New Jersey

Caroma (Australian) Water-saving Plumbing Fixtures
Peter Goodman, Goodman Sales
North Arlington, New Jersey



**July 9th Guest Lea Cullen Boyer,
GreenGuruNetwork
with Bill and "Dino"**

**Live In-studio guests each show
call-ins to 914-693-5700
tech-info, "green" music**

Hosted by: Bill Bobenhausen, FAIA, LEED AP

1230 WFAS AM (Westchester/surrounding areas)

Live Internet <http://wfasam.com>

info: <http://www.wfasam.com/BillsGreenArchitectShow.html>

**[Executive Editor:](#)
[SDC President](#)
[Bill Bobenhausen](#)
[FAIA CCS LEED AP](#)**

POWERLESS and POWERFULL

[SDC Projects](#)

POWERLESS

The current and expected extreme heat wave this week reminds me of major New York blackouts past.

[AIA/CEU Continuing Ed](#)

[Past SDC Newsletters](#)

In November of 1965 the power went out for about twelve hours. When it did, I was a junior at Brooklyn Tech, and was in a barber chair getting a haircut with an electric trimmer. I remember walking home with half of my head trimmed. More importantly, almost all in the city took the dilemma in relative stride.

[SDC Home Page](#)

[About SDC/Contact](#)

[LEED Services/Gold Projects](#)

July of 1977 delivered what the New York Times described as the "bad blackout" - with the city lacking both electricity and the ability to stop widespread arson and looting.

[NYSERDA Provider](#)

In August of 2003 the largest power disruption in North American history occurred and calm prevailed. Congressman Peter King noted: "Maybe it's because of 11 September, maybe it's the New York spirit, but there's

been very little panic of excitement, people are coping with it."

This week, the temperature is predicted to reach about 100 degrees several days in a row - and at the end of a work week after days of peak electrical thirst. Hopefully diversity, common sense, good planning by Con Edison and NYSERDA, and perhaps a little luck like a well timed thunderstorm will get us through.

Member:

**American Institute of
Architects National**

AIA New York State

**Construction
Specifications Institute**

**International Code
Council**

**USGBC National
USGBC Urban Green
USGBC New Jersey
USGBC Long Island**

POWERFUL

We ALL take our energy needs and supply for granted to one degree or another. Until several decades ago, almost all utilities projected that the demand for power must and will continue to grow - and more and more generating capacity must be put online.

Con Edison first reached the 10,000-megawatt (MW) generation mark in 1988, more than 100 years after beginning operations at their Pearl Street Generating Station. By 1997, electrical demand topped 11,000 megawatts - broke 12,000 in 2001 - and surpassed 13,000 in 2005. Interestingly, the 2009 peak demand was just 12,242 MW. Many factors contribute to peak electrical demand - but the simple numerical fact is that the peak demand in 2009 was lower than in 2005. Such a reduction would have been unimaginable forty years ago.

Today, environmental and economic realities, and technological advances have shifted the emphasis strongly to conservation. And Con Edison now invests billions to strengthen its energy delivery systems and promote conservation.



@BillFAIALEED



***NE view from top floor of WTC 7
(during Urban Green Meeting)***

**NYSERDA - New Construction Program Assistance
Funding Still Available**

An Independent Contractor to:



Applications have slowed due to the economy. But all New York based Owners and Architects of substantial projects should still consider the substantial life-cycle benefits of the NYSERDA New Construction Program. Benefits and incentives are maximized if identified EARLY in the design process (i.e., schematic design). Our firm, Sustainable Design Collaborative LLC, serves NYSERDA as one of only fourteen Technical Assistance (TA) providers in downstate counties.

For detailed program info go to the link below. After reviewing that information, please contact bill@sdcollab.com to discuss timing and options for NYSERDA NCP program participation.

The NYSERDA program summary can be found at:

http://www.nyserda.org/programs/new_construction/faqs.asp

SDC Summer Solstice Party at Maud's Tavern HOH - June 21, 2011 Next: Winter Solstice on December 21st



Nice time had by all. Bill saying goodbye to Julian Pennington who manages his 1230WFAS-AM radio show. Glimpse of Hudson and Palisades near sunset in the background.



**Hastings-based 'Solar Punch' band.
Rockin' for our party on solar power. On to
perform in India and elsewhere next.**

NEWS

July 20, 2011 - Catholic Charities - Bronx Thrift Store

Officially LEED-NC version 2.2 Certified (receiving 28 out of 28 points requested). Credits: Paul Buck Architect; AMA Engineers; EME (NYSERDA Modeling & Commissioning); John O'Hara Company (GC); Sustainable Design Collaborative LLC, LEED Consultant (Jin Huang, Project Manager).

July 20, 2011

**Received e-mail today with the subject line:
Is Passivhaus a Waste in Warm Climates**

**My retort:
Should blind pigs be allowed to drive?**

Just trying to be constructive - In short, information distributed in the name of "green advice" must be unambiguous and technically sound. Titles should not improperly promote doubt or undue concern - and text should be prepared by someone with real knowledge of the subject (beware of copy editors!). The very basis of "passive design" in the context referenced is to provide heat in winter in climates that need it. Moreover, the article goes on to misrepresent and simplify insulation benefits in warm climates. Remember, the best answers usually depend on weighing various applicable factors. There are more than enough media problems in the world today without muddying up proven practices in the "green field" as well. Answer to my retort - let the pigs drive, but get the _____ out of the way!

SDC Project Updates

I



Nearing Completion:
Nassau Community College Life Sciences Building LEED Gold Goal: Cannon Design, Architects; Sustainable Design Collaborative LLC (Green/LEED)



Center for Sustainable Energy at Bronx Community College (BCC)
LEED NCv2.2 Silver (minimum projected)
Pre-GMP meeting with Harshad Lakhani PE;
Dr. Michael Seliger, BCC; architect Paul Buck

First Floor Lighting Plan (LEDs, T5, CFL)
7000 sf renovation on Hall of Fame Drive
(below)

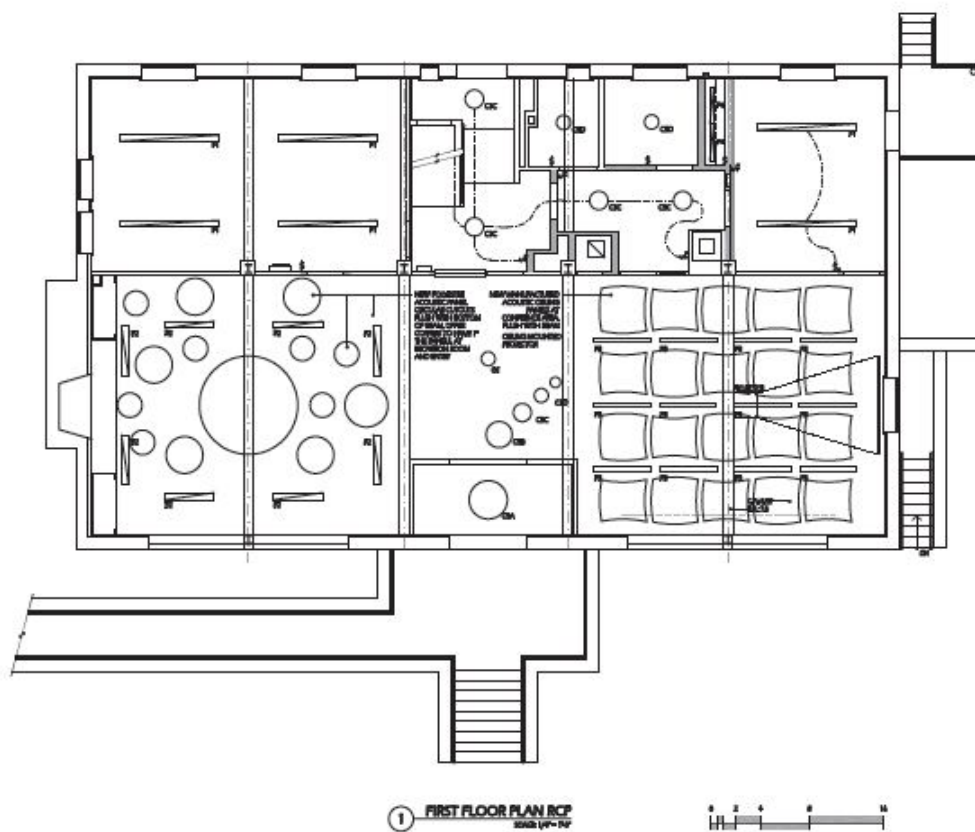

[Forward email](#)



This email was sent to bobenhausen@msn.com by bobenhausen@msn.com | [Update Profile/Email Address](#) | Instant removal with [SafeUnsubscribe™](#) | [Privacy Policy](#).

Sustainable Design Collaborative | 5 Boulanger Plaza | Hastings-on-Hudson | NY | 10706